

BRAND ▪ WEB ▪ WORD ▪ MARKETING ▪ MEDIA ▪ PRINT

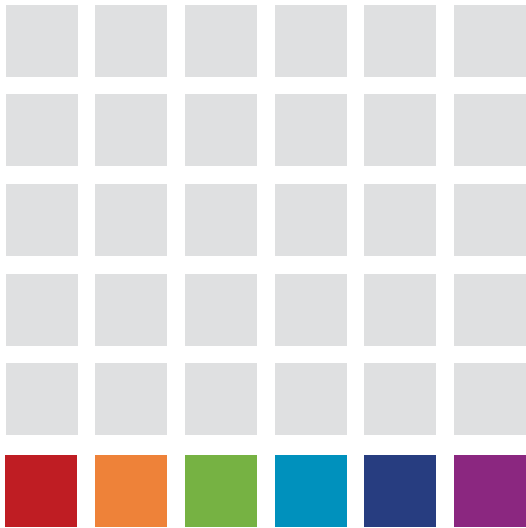

wilson design associates

DIRECT MAIL

We like to think our work speaks for us – but more importantly we know it speaks for **you**

Sustainable Pre-engineered Classroom : SPEC



FORDINGBRIDGE
inspiring • sustainable • design • build

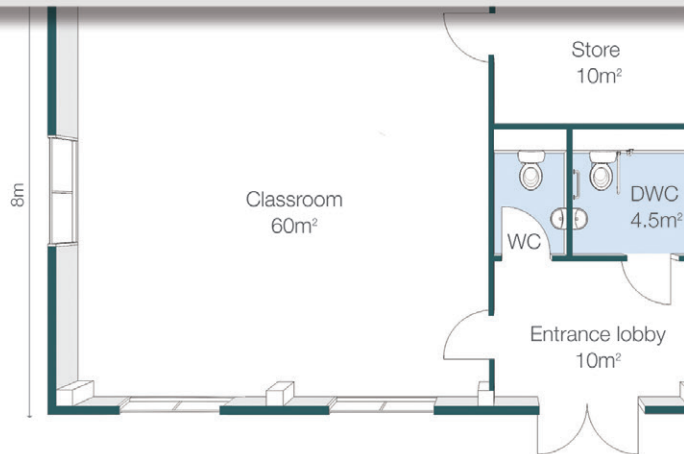

Our SPEC building is designed with multi-purpose use and flexibility of space in mind, offering a fully DDA compliant 30-pupil classroom, entrance lobby, storage area and adequate toilet facilities as shown in the floorplan. Prices from £180,000 + VAT.

Our proven high-quality construction methodology is built on 20 years of experience in the education sector. Call us to arrange a no-obligation FREE site visit and consultation on **01243 554455** or email us on kirstyhuxtable@fordingbridge.co.uk, or visit www.fordingbridge.co.uk.

FORDINGBRIDGE
inspiring • sustainable • design • build

➤ Initial Consultation ➤ Feasibility ➤ Design & Planning ➤ Construction ➤ Completion

At Fordingbridge we can deliver a Sustainable Pre-engineered Classroom (SPEC) in just 16 weeks from concept to completion. This permanent solution offers a quality energy-efficient teaching environment compared to the cheaper temporary options available today.

Our construction time is quick and efficient, causing minimal disruption to the school day and carried out by a CRB-checked installation team; a full health and safety compliance/accreditation is integral to our service.

Our SPEC building provides:

- an inspiring multi-use space designed to be flexible and versatile
- a permanent solution with a long lifespan, not a temporary fix
- sustainable, energy-efficient and cost-effective accommodation
- low maintenance and low running costs



Special features come in standard with a Fordingbridge SPEC building:

- Timber frame** - Our SPEC building is constructed from a robust timber frame, ensuring a long lifespan and a warm, natural interior.
- Super insulation** - Our insulation is made from high-quality, non-toxic materials, ensuring a warm and comfortable interior.
- Air tightness** - Our building is designed to be airtight, ensuring a warm and comfortable interior.
- Intelligent lighting system** - Our building is equipped with a smart lighting system, ensuring a warm and comfortable interior.

THANK YOU

LOOKING AFTER YOU AND YOUR FAMILY



LIGHTING THE WAY FOR FUTURE GENERATIONS



Thank you so much for using my services, I hope you are happy with the advice and the solutions I have provided for you and your family.

Please accept my gift of a **Matryoshka doll** which represents the generations of family that you are looking after with the actions you have taken.

I have also included a pack of referral cards that I hope you feel comfortable passing on to your family and friends whom you think may also benefit from my advice and service.

For every new client that I help from your introductions I will give you a gift card for you to buy something special as a treat for you and your family.

My best wishes to you and the generations you are looking after.



ANDREW UPTON

07540 253155
hello@beaconadvice.co.uk
www.beaconadvice.co.uk

LIGHTING THE WAY FOR FUTURE GENERATIONS



WILLS • TRUSTS • LASTING POWER OF ATTORNEY

FREE CONSULTATION WITHOUT OBLIGATION

I look forward to meeting you and advising you on the best way to protect your assets for yourself and for your future generations.





ANDREW UPTON

07540 253155
hello@beaconadvice.co.uk
www.beaconadvice.co.uk







THE FIRST SLAB IS ON US!

Our patio slabs may look good enough to eat... but they will break your teeth!

Unlike this lovey Chocolate Bar for you to enjoy while you look through the box!

The box is full of useful and inspirational ideas for your new home!

PRIMETHORPE PAVING

Cadbury DAIRY MILK 110g



Need something? Get in touch!
01733 810161
sales@primethorpepaving.co.uk

PRIMETHORPE PAVING

**NEW HOME
NEW SPACE
NEW IDEAS**

In this box you'll not only find this edible slab, you'll also see:

- A booklet full of useful tips and tricks on how to transform your new-build garden.
- A planning booklet for you to get your imagination going.
- A tape measure that you never know when you might need!
- And a bunch of other goodies for you to discover and enjoy.

...AND A GOLDEN TICKET!
SCAN THE QR CODE FOR
A CHANCE TO WIN IN
OUR COMPETITION!

Take a look around our... there's so much to see!

High-Quality Paving & Landscaping Products
www.primethorpepaving.co.uk



YOUR GOLDEN TICKET!

MONTHLY PRIZE DRAW

SCAN THE QR CODE FOR A CHANCE TO WIN!

PRIMETHORPE PAVING





Win a patio installation from Primethorpe Paving!

We hope the contents of your welcome box have sparked some fantastic ideas for your outdoor space. Are you ready to bring those ideas to life? Enter our grand prize draw to win a patio installation that perfectly reflects your vision.

Bonus Draw!

Simply by entering the huge patio draw, you'll also be automatically included in our next monthly draw to win one of the stunning rainbow sandstone planters shown above. So why not get your name into the hat today!

Full details of the competition rules and T&Cs can be found on the entry page - just scan the QR code!

SCAN THE QR CODE FOR YOUR CHANCE TO WIN!

PRIMETHORPE PAVING



We wouldn't have the great reputation we have or be recommended so often without brilliant clients like you Tony. So thank you for being the best.*

Everything we do, we do it for you... cheesy, yeah, but true! No, really, here at Wilson Design we love being creative on projects that help you win more business. As our strapline says: we like to think our work speaks for us – but more importantly we know it speaks for **you**.

So, as we enter our **20th birthday year**, why not get in touch and make this another great year for **us and you too**.

Visit **www.wilsondesign.uk.com** to see what we have been **creative with recently** in our blog and portfolio; there may be something there that would **work for your company**.

Best wishes for the Festive Season and the New Year!

Steve Wilson

* It's important that we let you know we actually love ALL of our clients and it would be unfair to have just one favourite... but we really do think you're fabulous!

Tony Hedger
A & T Business Ass Ltd
2 Plantation Way
Worthing
BN13 2AF

*P.S. As it is our 20th birthday year, we have a gift for you...
order before the end of January and get 20% off all print costs.*

wilson design associates

Metro House Northgate Chichester West Sussex PO19 1BE
T 01243 787100 E studio@wilsondesign.uk.com www.wilsondesign.uk.com





Don't tell
everyone Mark
but you're my
favourite...
... I bloody well
love you!

Whether he was the first to say it or not, Oscar Wilde is often credited as the originator of the saying:

"You never get a second chance to make a first impression"

Here at Chichester Print we feel you should be making those all important first impressions better than your competitors! That is why we are members of the EC and try to implement all we have learnt from Nige and the team – and our own BGA, Karl, of course!

We can help you implement all you are learning in true EC style... so get in touch and we will make your ideas come alive.



Chichester Print

Metro House Northgate Chichester PO19 1BE
01243 787100 studio@chichesterprint.co.uk
www.chichesterprint.co.uk

Entrepreneur's
CIRCLE



It's not your
customers' job
to remember
to do business
with you.

It's your job to
remind them.

Karl Anscombe
YOUR BGA

karl@nigelbotterill.com
07792 368 309



Thank you for helping me make
my first year as **YOUR BGA** such a
fantastic one! It wouldn't have
been the same without brilliant
members like you.

So thank you for being the best.*

Everything we do, we do it for you... cheesy, yeah, but true! No, really, here at Nigel Botterill's Entrepreneurs Circle we love being hands on and helping great businesses like yours to win more business... and I'm passionate about my EC members here in the South East.

In my first year as **YOUR BGA** I have been fortunate to get over **75%** of local members participating in meetings and engaging with me... and each other... fantastic news for everyone involved... let's see if we can get that figure higher over the coming year.

Together we can make a highly effective local business community right here across the South East... get involved as **participation is key!**

Karl

* It's important that I let you know I actually love ALL of my members and it would be unfair to have just one favourite... but I really do think you're fabulous!

Give your business a boost!



You'll be shocked
how affordable
our bookkeeping
services are!

Call us now: 03309121828
Trader**mate**

It may help you work, rest and
play but it's bloody useless at
doing the accounts!



But we're brilliant at
bookkeeping, so give us a call
and see how we can help you!

Call us now: 03309121828
Trader**mate**

Who said running
your own business
was a picnic?



Our bookkeeping services
will give you more time to
do what YOU DO BEST!

Call us now: 03309121828
Trader**mate**

Don't blow a fuse!



You'll be shocked
how affordable
our bookkeeping
services are!

Call us now: 03309121828
Trader**mate**

Doing your accounts
shouldn't be a marathon!
But this should be!



We'll put the miles in so you
have enough energy left to
run your business!

Call us now: 03309121828
Trader**mate**

When it comes to
sorting out service charges,
we'll go to any lengths.



Service charges. They're not why you went into business.

We'll take them all off your hands. Our end-to-end approach covers everything – from setting the charges in the first place, through to apportionment, invoicing, reconciliation and RICS-approved certification.

Best of all, it won't cost you anything. Our fees can be part of the charges.

To see how it all measures up, call Giles Musson or Steve McDermott on 020 7079 3950.



JONATHAN JAMES
CONSULTANCY LTD

T: 020 7079 3950 E: info@jjcl.co.uk www.jjcl.co.uk

We've got the measure of
service charges.

There's no need to waste time on service charges. We'll do it for you – and it's effectively free.

You can include our fees within the charges. Leaving us to set annual budgets. Apportion costs between tenants. Issue the invoices. And reconcile at year-end. Providing independently verified, RICS-approved certificates.

We've been doing this for more than 20 years. So, to draw a line on service charge admin, call Giles Musson or Steve McDermott on 020 7079 3950.



JONATHAN JAMES
CONSULTANCY LTD

T: 020 7079 3950 E: info@jjcl.co.uk www.jjcl.co.uk



JONATHAN JAMES
CONSULTANCY LTD

Mr S Wilson
Wils

NOTE TO SELF:

Swap service charge
certification for
something more
satisfying.



Service charge rules start in April.
Now that, calling JJCL is a **must**.

Charges in Commercial Property.

Anyone involved in the management of service charges **must**

things you should do.



JONATHAN JAMES
CONSULTANCY LTD

www.jjcl.co.uk

020 7079 3950



So when it
and issuing

spend

Make sure you're not breaking RICS' rules.

McDermott or Giles Musson now on **020 7079**

Henry Wood House, 2 Riding House Street, London W1W 7FA T: 020 7079 3950 E: info@jjcl.co.uk www.jjcl.co.uk

Registered Office: 1 Dukes Passage Brighton East Sussex BN1 1BS Registered No. 5742790 Regulated by the Royal Institution of Chartered Surveyors

wilson design:works

We like to think our work speaks for us – but more importantly

we know it speaks for you

Issue 1: November 2012



Welcome to our first newsletter!

Having designed and printed newsletters for many of our clients with great success, I thought it was about time we did one for ourselves.

We have been involved in some great projects this year and produced work that we are very proud of... so let's show you some of it! I hope you find the content impressive and inspiring and that there is something here that you can adopt, adapt and implement in your own business to help you succeed and grow.

There are now so many ways that you can communicate with existing and prospective clients, you have to ask yourself: are you using enough of them and often enough? From e-shots to exhibitions, there are lots of ways to get your message out there – ***we can help you achieve all of them!***

Win new business with direct mail

With postal costs having risen considerably, fewer businesses than ever are using direct mail as an effective marketing tool – that's why there has never been a better time for you to use it! With so few other people using it you have a much better chance of making a big impact. Whether it's sales letters, brochures or leaflets, as long as you make them interesting and eye catching you're on to a winner.

An essential feature of any direct mail campaign is making sure that the recipient finds the mailer interesting enough to want to find out more. If you use envelopes make them stand out to give you a better chance of them actually being opened or alternatively send a postcard.

These are three postcards from a series of six which we sent out a while ago. They had a great impact and got lots of people talking. Pinned to noticeboards and passed around offices – these colourful cards have a good shelf life and great marketing value.

If you would like to get in front of your existing and prospective clients, there is no better way than direct mail. ***Go on give it a go!***



wilson design:works

We like to think our work speaks for us – but more importantly

we know it speaks for you

Issue 2: February 2013



Promote your business with passion!

It's February, the month of love and passion! And Valentine's Day is the perfect opportunity to sell to or at least communicate with your clients with great results!

At WDA, we have sent a sales letter, an email newsletter, used social media and sent this printed newsletter – all with a compelling offer and a call to action. By the way, you can find our fantastic Valentine's gift to you inside!

There are so many times during the year that you can engage with your customers and remind them to buy from you. All you need is a little advance planning. It doesn't have to be a whole year's marketing strategy (though that would be brilliant) but you do need to think a few months ahead and make it all tie together. ***We can help you achieve it!***

Autotrade-mail go direct

Autotrade-mail really appreciate the importance of using effective, cost-efficient marketing materials in getting their message across to their members. We have worked with the company for several years on a variety of projects, the latest of which was to design, print and organise mailing for their latest direct mail campaign.

The campaign introduced members to the new Autotrade-mail Gold Reward Scheme and included an information brochure, introductory letter and membership reward card. The letter and reward card were personalised with member-specific information.

How are you connecting with your clients?

Just give us a call to find out more about how we can help you communicate more clearly, more effectively and more directly.



wilson design:works

We like to think our work speaks for us – but more importantly

we know it speaks for you

Issue 3: October 2013



No excuses!

It's not your customers' job to remember to do business with you, it's your job to remind them! How many times have you heard that said at a business seminar or networking event? So what are you doing about it right now? What marketing do you have in place to remind them this week?

When you communicate with your customers, and prospective customers, using multiple types of media then you significantly increase the results that you get. Whether it's email marketing, direct mail, newsletters, website, social media or exhibitions, you need to be contacting them regularly and with a consistent brand message and call to action.

Your database of contacts is going to waste if you simply don't make use of it! It's your most effective resource for selling so make the most of it. Use all the means of communication you can to remind your customers why they should be buying from you – ***we can help you with all of this!***

Seriously impressed!

We love it when our clients let us know how happy they are with the work we do for them (we have already had a fantastic testimonial from HDRC about how impressed and pleased they are with their new site) but we love it even more when they let us know how happy ***their clients*** are!

HDRC sent us an email with this comment from one of their members who had recently used the booking system on the website: "Just a quick note to say that I've just used your website to enter the Hunter Trials on 21 April. I'm seriously impressed with your website. You could teach most large consumer organisations a thing or two about ease of use and functionality. Well done!"

Nice to know what we do works and is appreciated, not just by our clients but by the people they are selling to as well!

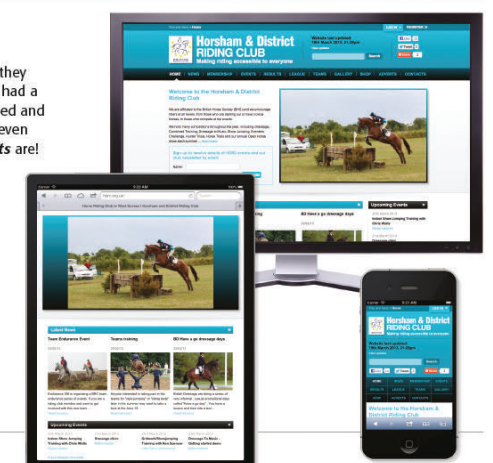



Newsletter

Spring 2012

OXFORD OFFICE

New Abbey wins national award

Mucknell Abbey, a new Church of England Monastery in Worcestershire for a contemplative Benedictine monastic community, has been awarded the coveted President's Award from EASA (Ecclesiastical Architects and Surveyors Association) and the National Churches Trust. The award was presented at Westminster Cathedral shortly after the Abbey had been inaugurated by Dr. Rowan Williams, Archbishop of Canterbury.



Photo: Dr Rowan Williams presiding at the inauguration ceremony in the Oratory.

Designed by Acanthus Clews Architects of Banbury, the scheme is part refurbishment and part new build. Guest rooms, refectory and ancillary accommodation are located within converted 19th Century brick barns and a new community building replaces a historic farmhouse to complete a courtyard environment. At the heart of the Monastery is the new Oratory, a lofty vaulted space designed for prayer and worship. The project was completed on time and within budget, with Baqus providing full quantity surveying and cost management services.



Tel: 01865 241159
Website: www.baqus.co.uk

About Baqus

Baqus brings together a range of long established construction consultancies with the shared philosophy of providing an enthusiastic, proactive and personal service to every client. The company has wide-ranging experience in the market sectors within which it operates and clients are provided with the continuing involvement of a director in every project. Both innovative and forward-looking, Baqus is a strong, confident consultancy with a prolific history, able to meet and exceed client expectations.



Clive Sayer
Chief Executive Officer
@CliveSayer

Baqus Charity of the Year

Baqus is pleased to announce Article 25, the UK's leading built environment charity, as our Charity of the Year for 2012. We shall be raising money to provide funds for their post-disaster reconstruction projects around the world, bringing construction expertise to the people who need it most.



The decision to have a Charity of the Year is a new initiative that will support our commitment to Corporate Social Responsibility and encourage employees to actively participate in fundraising events. These will include the "Gold Challenge", an initiative promoted by the British Olympic and Paralympic Association which offers the opportunity to take on a variety of Olympic sports during 2012.

For further information about Article 25 and its projects, please visit: www.article-25.org

News from across our business

- Olympic sailing facility at Weymouth and Athletes Village at Portland completed in good time for July.
- Cabinet Office buildings refurbishment in Whitehall completed

Harefield Lord Adonis

The 26th January saw the completion of the new student accommodation at the Harefield Lord Adonis. The new student bedrooms are built using a modern staff flats. Built using a modern academy to have its own cost manager for the project.



Sixth Form Centre completed

St Benedict's RC High School, Alcester has built a new 2,000m2 Sixth Form Centre, enabling the school to offer Post-16 education for the first time. This impressive building, designed by TSH Architects, is aspiring to BREEM "Excellent" and is being put forward for a series of design and sustainability awards. As cost advisors, we developed innovative sustainable solutions whilst achieving exceptional value for money and robust adherence to our client's budget.

The three-storey building with atrium has been designed as a sustainability exemplar, in a manner which is clearly demonstrable to the students and is intended to act as a powerful teaching aid. Technologies include a biomass boiler using wood pellets from local sustainable sources, full rainwater harvesting, and automatically controlled natural ventilation systems. Powerful external building elements include curtain walling, terracotta and aluminium, complemented by zinc rainscreen cladding panels, aluminium windows and external doors.

Our Oxford office works on a wide range of school projects, both in the state and private sectors, including long-term frameworks and much repeat business. Our bespoke cost database for education work enables us to forecast out-turn costs with exceptional accuracy.



Worcester College



Having been quantity surveyors for recent projects, we have assisted with the evaluation of a national architectural competition for a new development at the main Walton Street site.

Day Opportunity Centres Go Ahead

Under an existing framework for Buckinghamshire County Council, Baqus has been appointed as quantity surveyors and CDM Co-ordinators for a series of five Day Opportunity Centres at Aylesbury, Buckingham, Chesham/Amersham, High Wycombe and Burnham in conjunction with the Oxford office of ADP Architects.



Abingdon Community Hospital Stroke Rehabilitation Gym

Extension to "Oxford Method" prefabricated ward to provide new rehabilitation gymnasium facilities for group therapy in a specialist facility which clusters together the most complex and frail elderly patients from hospitals across South Oxfordshire.



Woodlands House Forensic Hospital, Aylesbury

Refurbishment with replacement of en-suites, damp-proofing and anti-ligature works, de-escalation space and seclusion room to 20-bed low secure unit. Micro-managed in ten phases with tight handover, decant and changeover between phases.



Restoration of Bronze Age Copper Mines

Ecton Copper Mines are a remarkable complex of industrial remains partly owned by the National Trust in Staffordshire on the edge of the Peak District National Park. They include two main buildings (engine house and powder store) and associated structures such as part of the chimney, walling for the horse gin-wheel and the main shaft. The engine house is within a Scheduled Ancient Monument and the surrounding area is a Site of Special Scientific Interest.

Baqus have been appointed to provide cost advice, tender documentation and tender analysis for the Management Plan for archaeological remains. The lead consultant is Keevil Heritage Consultancy from Didcot, with whom we have also worked on the restoration of Medieval Defences for Coventry City Council.





As a rule...

...we will get you more money for your unwanted trade vehicles
& stronger real-time bids on non-franchise px's you are trying to deal on



It's free to try, call:
01243 772200

Come and see why we are the UK's most recommended real-time vehicle trading club

	2001/02	2002/03	2003/04	2004/05	2005/06	2006/07	2007/08	2008/09	2009/10	2010/11	2011/12	2012/13	2013/14	2014/15	2015/16	2016/17	2017/18	2018/19	2019/20	2020/21	2021/22	
Mar-Aug		02	03	04	05	06	07	08	09	10	11	12	13	14	15	16	17	18	19	20	21	
Sept-Feb	51	52	53	54	55	56	57	58	59	60	61	62	63	64	65	66	67	68	69	70	71	and so on until 2050



£40 per month plus vat **No other buying or selling fees**
Quick & simple to use Vetted dealers only
No contracts **No price increase guarantee**
It's even free for you to try...

**Try us with your overage, duplicate, non franchise underwrites
& unwanted trade vehicles. Get better bids.**

Cartotrade is brought to you by the original Autotrade-mail management team



01243 772200

10 Celebrating our 10th Anniversary

BUSINESS TRAVEL SOLUTIONS LIMITED
Peace of mind for business travellers

BUSINESS TRAVEL SOLUTIONS LIMITED
Peace of mind for business travellers

All you have to do is call us next time you intend to travel on business and we can organise your flights, visas, car parking and lounge access

MADE HOLIDAYS
special anniversary, honeymoon, etc.

TICKETS
(UK and Broadway)

TRAVEL RESERVATIONS AND FLOWER DELIVERY SERVICE
for those forgotten special dates

- MEET AND GREET SERVICE
Heathrow, Gatwick, Stanstead, Edinburgh, Manchester
- CAR HIRE
- HOTELS
- RAIL TICKETS
- FERRY AND EUROSTAR BOOKINGS
- INCENTIVES – SMALL GROUPS

BUSINESS TRAVEL SOLUTIONS LIMITED
The Tree House Fairfield Mews
Ashington West Sussex RH20 3DQ
01903 892444 info@biztrip.co.uk
www.biztrip.co.uk

BUSINESS TRAVEL SOLUTIONS LIMITED
Peace of mind for business travellers

All you have to do is call us the next time you intend to travel on business and we can organise hotels, trade fairs, dinner reservations and theatre tickets

for those forgotten special dates

- THEATRE TICKETS
(UK and Broadway)
- AIR TRAVEL
Full service airlines
No frills carriers
- CAR HIRE
- VISA AND PASSPORT SERVICE
- TAILOR MADE HOLIDAYS
special anniversary, honeymoon, birthday etc.
- FERRY AND EUROSTAR BOOKINGS
- RAIL TICKETS
- CAR PARKING AT AIRPORTS
- TAXI TRANSFERS
- LOUNGE ACCESS
- MEET AND GREET SERVICE
Heathrow, Gatwick, Stanstead, Edinburgh, Manchester
- INCENTIVES – SMALL GROUPS

BUSINESS TRAVEL SOLUTIONS LIMITED
The Tree House Fairfield Mews
Ashington West Sussex RH20 3DQ
01903 892444 info@biztrip.co.uk
www.biztrip.co.uk

BUSINESS TRAVEL SOLUTIONS LIMITED
Peace of mind for business travellers

All you have to do is call us next time you intend to travel on business and we will organise every aspect of your trip including car hire, parking at airports, and taxi transfers

BUSINESS TRAVEL SOLUTIONS LIMITED
Peace of mind for business travellers

- ESTA: Electronic System for Travel Authorisation
- After 12th January 2009 all travellers must be approved for travel to the United States via air or vessel
- Travellers also transiting through the United States under the Visa Waiver Program must also possess an approved Travel Authorisation after 12th January 2009
- This can be done online at <https://esta.cbp.dhs.gov>
- Early application is advised

BUSINESS TRAVEL SOLUTIONS LIMITED
The Tree House Fairfield Mews
Ashington West Sussex RH20 3DQ
01903 892444 info@biztrip.co.uk
www.biztrip.co.uk



01243 869905

Fan Coil/Resilient Mount Motors

Available with outputs up to 750watts at 4 & 6 pole. Double and single shaft versions available.

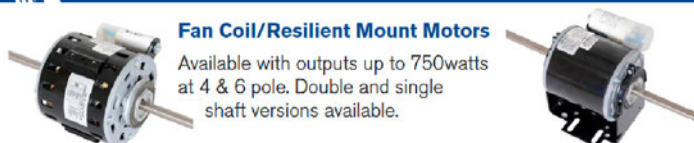

Radial Mounts/Blower Motors

Mountings include the 3 arm radial mount, lug mount and end shield mount. Outputs up to 1400watts with models available from 4 to 6 pole.

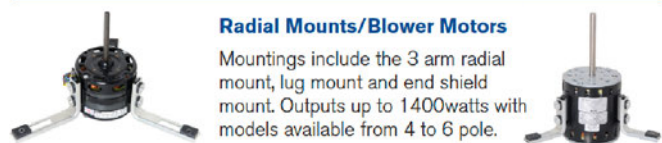

B56/60 Range

(new models manufactured in the UK)

Available as mechanically rated, evaporator and totally enclosed fan cooled models. Outputs up to 1400watts from 2 to 8 pole. Mountings available include solid foot, resilient mount and flange.



Skeleton Motors

(new models manufactured in the UK)

Shaded pole motors with outputs up to 18 watt. Various mountings and shaft dimensions from stock.



33 Frame

(new models manufactured in the UK)

Outputs up to 100watts from 2 pole to 6 pole. Mounting options include stud, tapped hole, foot mount or bracket. Plain shaft and fan hub available.



Unique modifications available



SALES@REMCO.CO.UK

Axials

154mm to 710mm blades, motors from 2 pole to 8 pole. Single and three phase, Terminal Boxes if required. Plate fans also available.



Backward Curve

Diameters from 133mm to 250mm from stock. Provide quiet, efficient performance, most effective in high static pressure applications.

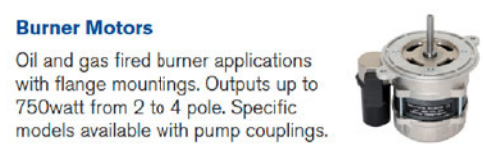

Burner Motors

Oil and gas fired burner applications with flange mountings. Outputs up to 750watt from 2 to 4 pole. Specific models available with pump couplings.

Accessories

Remco offers a wide selection of accessories including fan scroll wheels, blades, mounting kits and plates, speed controllers, capacitors and many more.

Our experienced team are also on hand to fabricate one off pieces for specific applications.



01243 869905

Elco refrigeration

Remco is the UK distributor of Elco motors. Elco are industry recognised as a superior motor manufacturer with over 50 years experience in the production of fan motors for refrigeration and airconditioning applications.



ELCO ECM

The industry is changing!!!

Elco has designed a range of Electronic Commutated Motors (ECM) for use in commercial refrigeration applications. Increased efficiency assures energy saving of up to 80% to meet the parameters set by current legislation.

Elco's engineers are at the forefront in the development of ECMs, allowing Remco to continue supplying the high standard of motors that our customers expect. Elco engineers have now developed their 4th generation of ECM leading to increased reliability and durability.



PRODUCT OVERVIEW



Electric Motors
Axial Fans
Backward Curved Fans
Centrifugal Blowers
Motor Start & Run Capacitors
Parts & Accessories
Refurbishment

REFURBISHMENT

Remco offers a fan deck and blower unit refurbishment service. Our aim is to remove all the hassle from replacing old motors and damaged fan wheels from dirty units. With a FOC collection service, we can refurbish your current unit at a fraction of the cost of replacing it new. Remco's experienced team in our fully equipped workshop can refurbish and return your units, usually within days. Alternatively, if you are able to visit us in Bognor Regis, we can refurbish your unit whilst you wait.



The refurbishment includes FOC collection and inspection on arrival, followed by a no obligation quote. Once the quotation is approved each unit is then disassembled, thoroughly cleaned in our specialised industrial cleaning unit and then reassembled using replacement components, only where necessary and a new motor. The unit is then tested prior to a speedy despatch.

All work carried out is also covered with Remco's 12 month warranty!

We take great care to make sure we only replace those components which are unserviceable. This keeps your cost to minimum and less than the cost of a complete new unit.

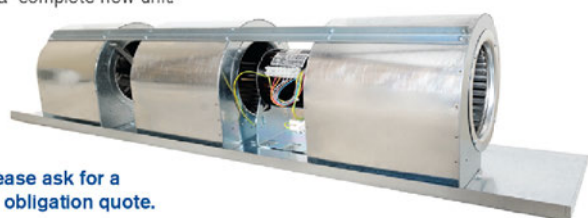

Please ask for a no obligation quote.

REMCO SERVICE

Remco has been supplying the industry with replacement powered motors and accessories for over 30 years.

With the backing of the Regal Beloit Group, Remco is now larger, fully equipped premises and we are developing our include an increasing number of UK manufactured motors.

Elco is also part of our group and only Remco and our appointed distributors are able to offer their quality range of replacement motors for the refrigeration industry.

Our business here at Remco was built on the foundations of strong technical support and excellent customer service. Our aim is to maintain these high standards.

Delivery options

Standard (2/3day) parcels.

Next day parcels: Pre 12pm delivery; Pre 10am; Pre 9am.

For a next day service, please send us your order by 4pm. Contact time and we will still do our utmost to despatch your parcel.



Unit 12, Castle Grove Business Park
Bognor Regis, West Sussex

T: +44 1243 869905 F: +44 1243 810799 E: sales@remco.co.uk

www.remco.co.uk

REGAL

A Regal Brand



LIGHTING THE WAY FOR FUTURE GENERATIONS

BEACON
ADVICE



LOOKING AFTER THE FAMILY CIRCLE

MORE THAN
60% OF ADULTS
IN THE UK DO
NOT HAVE A WILL



NOW THAT TAKES
THE BISCUIT!



ANDREW UPTON
07540 253155
hello@beaconadvice.co.uk
www.beaconadvice.co.uk

HELLO!

As a Will writer, I offer a crucial and unique advantage in financial planning, which is in-depth knowledge about the beneficiaries, also known as the **'family circle'**. Collaborating with me will offer you several significant benefits:

Continuity: Knowledge of the **'family circle'** can help ensure funds remain within your management, maintaining service continuity.

Personalised Advice: Understanding beneficiaries aids in offering tailored advice, enhancing client satisfaction.

Referrals and Growth: Being a trusted adviser for future beneficiaries can lead to referrals and longevity for your business.

In essence, a collaboration with a Will writer enables financial advisers to deliver a future-focused strategy that benefits all parties involved.

I would be delighted to come and meet you to discuss further how we may work together to make the **'family circle'** complete.

Yours sincerely,

Andrew Upton

P.S. I hope you enjoy the complimentary biscuits that came with this letter!



MORE THAN 60% OF ADULTS
IN THE UK DO NOT HAVE A WILL



NOW THAT TAKES
THE BISCUIT!



LOOKING AFTER THE FAMILY CIRCLE

HELLO!

As a Will writer, I offer a crucial and unique advantage in financial planning, which is in-depth knowledge about the beneficiaries, also known as the **'family circle'**. Collaborating with me will offer you several significant benefits:

Continuity: Knowledge of the **'family circle'** can help ensure funds remain within your management, maintaining service continuity.

Personalised Advice: Understanding beneficiaries aids in offering tailored advice, enhancing client satisfaction.

Referrals and Growth: Being a trusted adviser for future beneficiaries can lead to referrals and longevity for your business.

In essence, a collaboration with a Will writer enables financial advisers to deliver a future-focused strategy that benefits all parties involved.

I would be delighted to come and meet you to discuss further how we may work together to make the **'family circle'** complete.



ANDREW UPTON
07540 253155
hello@beaconadvice.co.uk
www.beaconadvice.co.uk

Everything we do,
we do it for you...

Everything we do,
we do it for you...

...cheesy, sure, but true!

Here at Wilson Design we love being creative on projects that help you win more business. As our strapline says: we like to think our work speaks for us – but more importantly we know it speaks for **you**.

So, why not get in touch now and we can create something wonderful together!

Steve Wilson

P.S. Just because we love you, we have a gift for you...
order before the end of February and get 14% off all your print.

wilson design associates

T 01243 787100 E studio@wilsondesign.uk.com www.wilsondesign.uk.com



YOU JUST HIT THE JACKPOT!

CLAIM YOUR PRIZE OFFER!
 Call **01603 624832** or email **sales@victorygaming.co.uk**
 and quote ref: **777**

The very best fruit machines, jukeboxes and pool tables.



FRUIT MACHINES



JUKEBOXES



POOL TABLES

www.victorygaming.co.uk

We hope you are happy with our products and services and that you would feel comfortable referring our company to other pubs and hospitality venues that you know. As a thank you, we will give you £100 Amazon voucher when they become clients.

Our **PRIZE CHERRY** for you:
£100 Amazon voucher!

All you have to do to claim this prize is call **01603 624832** or email **sales@victorygaming.co.uk** and quote ref: **CHERRY**... let us know who you would like to refer and we'll do the rest!



www.victorygaming.co.uk

We are a leading independent supplier of fruit machines, digital jukeboxes, quiz machines and pool tables to the licensed trade.

Based in Norwich, we are ideally situated to provide an efficient and dependable service to the surrounding area including the whole of Norfolk, Suffolk and parts of Cambridgeshire and Essex.

We offer simple and competitive pricing with no hidden charges.

Our **JACKPOT OFFER** for you:
70% profit share
7 days a week for
7 weeks!

All you have to do to claim this offer is call **01603 624832** or email **sales@victorygaming.co.uk** and quote ref: **777**... we'll do the rest!



FRUIT MACHINES



JUKEBOXES



POOL TABLES



REFER SOMEONE ...AND GET A CHERRY ON THE TOP!

A £100 AMAZON VOUCHER!
 Call **01603 624832** or email **sales@victorygaming.co.uk**
 and quote ref: **CHERRY**





The Princess of Wales Conservatory

The Princess of Wales Conservatory is Kew's most varied glasshouse; opened by Diana, Princess of Wales in 1987 and named after Princess Augusta who founded Kew Gardens. The Conservatory houses ten different climatic zones covering a wide range of environments, from arid desert to tropical rainforest.

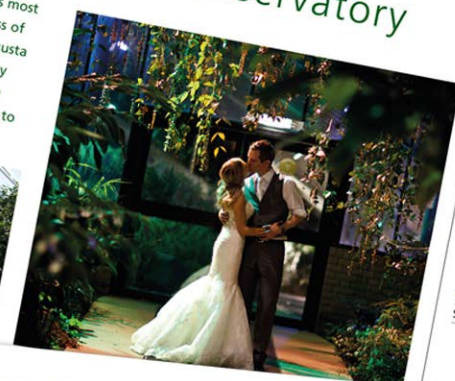

Capacities
Standing Reception 200

The Princess of Wales Conservatory

The Orangery

The beautifully restored Orangery was originally designed by Sir William Chambers in 1761, this stunning 18th century building was formerly filled with citrus trees and remains a central focus of Kew Gardens.



Capacities
Dinner Dance 200
Dinner 230
Standing Reception 400

The Orangery

The Royal Botanic Gardens Kew, a UNESCO World Heritage Site, offers a selection of spectacular and iconic event venues in our world renowned gardens.

Covering over 320 acres and situated on the banks of the River Thames, Kew Gardens is conveniently located just 6.5 miles from central London and provides an alluring retreat from the city. With over 30,000 different species of plants, Kew's living collection is the largest and most comprehensive in the world, making TW9 the world's most plant bio-diverse postcode.

Princess Augusta, mother of George III, founded the original Botanic Gardens in 1759 with a collection of rare plants. In 1772 Sir Joseph Banks became the unofficial director and dispatched explorers throughout the world to collect thousands of unknown specimens. It was largely under his influence that Kew became the world famous gardens and scientific institution that it is today.



Kew
ROYAL BOTANIC GARDENS
Tel: 0208 332 5641
Email: venues@kew.org
www.kew.org/venues

For more information, please contact us. We can help you to continue our work. Corporate, environmental 0208 332 5641 or venues@kew.org

www.willsondesign.co.uk
www.foundry-press.co.uk



Kew
ROYAL BOTANIC GARDENS

Kew
ROYAL BOTANIC GARDENS
Royal Botanic Gardens, Kew,
Richmond, Surrey, TW9 3AB
Tel: 0208 332 5641
Email: venues@kew.org
www.kew.org/venues

www.autotrade-mail.com 



An introduction...

www.autotrade-mail.com 

Tel: 01243 523000
Fax: 01243 523001



5th November 2012

Stephen Kerridge
Kerridges Needham Mkt
Garage
Wich Road
Needham Market
Suffolk IP8 5EG

Stephen

I'm very excited to bring to you the **ATM Gold Reward Club** along with your unique membership card.

From 1st December 2012 through simply using your ATM account, you will start to earn **Roadmiles** which can be redeemed against a host of rewards for your dealership. To get the engine running, we've started you with **100 complimentary Roadmiles!**

I do hope you will enjoy your rewards, you will find more details in the enclosed booklet but if you do have any questions please do not hesitate to get in touch.

ards
n Wyk
Support Manager

Autotrade-mail.com, the UK's leading online "real time" used car-trading network
Trader Publishing Ltd trading as Autotrade-mail.com

Postal Address: Autotrade-mail, Victoria Court, 22 St. Pancras, Chichester PO19 7GD • Email: sales@autotrade-mail.com

Trader Publishing Ltd is registered in England 03909628 • Registered Office: Cutbush Park Industrial Estate, Danehill, Lower Earley, Reading, Berkshire, RG6 4UT

Roadmiles – where will yours take you...



Introduction

Welcome to the ATM Gold Reward Club,
a thank you for your loyal custom.

From 1st December 2012 by simply using your ATM account, you will start to earn **Roadmiles** which can then be redeemed against a host of rewards for your dealership. To get the engine running, we've started you off with **100 complimentary Roadmiles!**

This booklet is designed to give you a taste of how you can initially earn and redeem your **Roadmiles**. Make sure you keep an eye on the website for the dedicated rewards section coming soon, which will feature the very latest offers as well as allowing you to keep a check on your **Roadmiles** balance.

Along with the rewards on offer, each month you will automatically be entered into a Monthly Prize Draw, exclusively for ATM Gold Reward Club members. Prizes on offer include an iPad, a Kindle or a year's supply of doughnuts! Winners will be notified each month and will just need to enter their card number into the website to claim their prize – so make sure you keep it in a safe place!

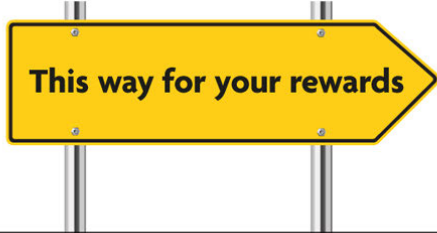

Month

Week

Monday ☐

Tuesday ☐

Wednesday ☐

Thursday ☐

Friday ☐

Saturday ☐

Sunday ☐

TO DO LIST

NOTES : IDEAS : PLANS

www.chichesterprint.co.uk • st

CHICHESTER
PRINT

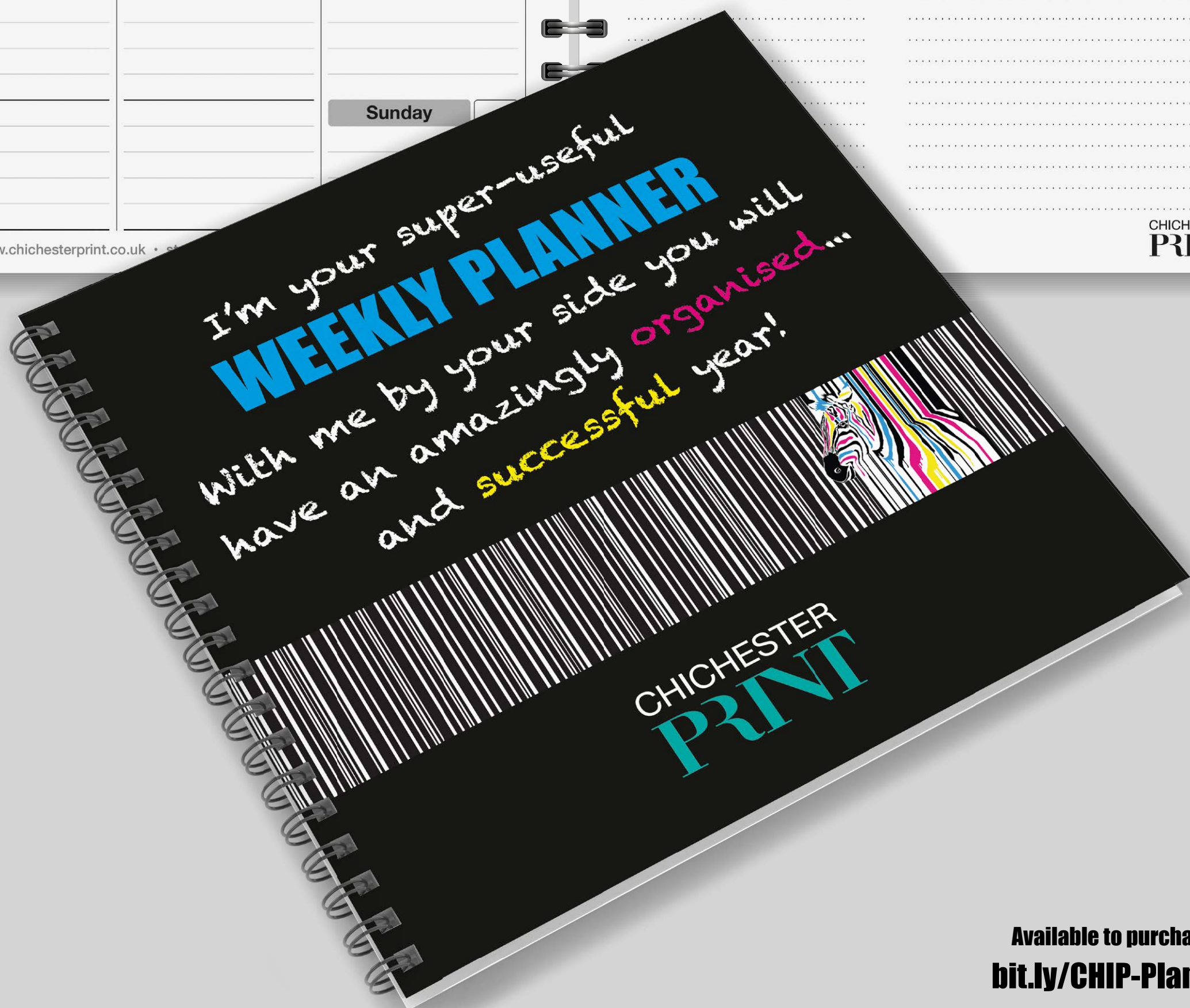

Available to purchase at:
bit.ly/CHIP-Planner

BRAND ▪ WEB ▪ WORD ▪ MARKETING ▪ MEDIA ▪ PRINT

wilson design associates



T 01243 276073 E steve@wilsondesign.uk.com www.wilsondesign.uk.com